



Single-Type B & C

Single-Type A

No. Teeth	Catalog Number	Outside Diameter	Type	Bore (inches)		Hub (inches)		Weight Lbs. (Approx.)	Type	Catalog Number	Stock Bore	Weight Lbs. (Approx.)
				Stock	Rec. Max.	Diameter	Length Thru					
7		3.350							A	100A7	1	1.2
8	100B8	3.770	B	1	1 1/4	2 5/16*	1 1/8	2.3	A	100A8	1	1.4
9	100B9	4.180	B	1	1 1/2	2 3/8*	1 1/4	3.2	A	100A9	1	1.6
10	100B10	4.600	B	1	1 5/8	3 1/8*	1 1/2	4.1	A	100A10	1	2.0
11	100B11	5.010	B	1	2 1/4	3 3/16*	1 3/8	5.3	A	100A11	1 1/4	2.5
12	100B12	5.420	B	1	2 1/2	4*	1 3/8	6.4	A	100A12	1 1/4	3.0
13	100B13	5.820	B	1	2 3/4	3 1/2	1 3/4	6.6	A	100A13	1 1/4	3.5
14	100B14	6.230	B	1 1/4	2 3/4	4 1/16	1 3/4	7.4	A	100A14	1 1/4	4.1
15	100B15	6.630	B	1 1/4	3	4 1/2	1 3/4	9.2	A	100A15	1 1/4	4.7
16	100B16	7.030	B	1 1/4	3	4 1/2	1 3/4	9.9	A	100A16	1 1/4	5.4
17	100B17	7.440	B	1 1/4	3	4 1/2	1 3/4	10.8	A	100A17	1 1/4	6.1
18	100B18	7.840	B	1 1/4	3	4 1/2	1 3/4	11.5	A	100A18	1 1/4	7.0
19	100B19	8.240	B	1 1/4	3	4 1/2	2	13.1	A	100A19	1 1/4	7.8
20	100B20	8.640	B	1 1/4	3	4 1/2	2	14.2	A	100A20	1 1/4	8.8
21	100B21	9.040	B	1 1/4	3	4 1/2	2	15.3	A	100A21	1 1/4	9.8
22	100B22	9.440	B	1 1/4	3	4 1/2	2	16.1	A	100A22	1 1/4	10.5
23	100B23	9.840	B	1 1/4	3	4 1/2	2	17.2	A	100A23	1 1/4	11.8
24	100B24	10.250	B	1 1/4	3	4 1/2	2	19.2	A	100A24	1 1/4	12.8
25	100B25	10.650	B	1 1/4	3	4 1/2	2	19.5	A	100A25	1 1/4	13.9
26	100B26	11.050	B	1 1/4	3 3/16	5	2	21.7	A	100A26	1 1/4	15.0
27	100B27	11.440	B	1 1/4	3 3/16	5	2	23.0	A	100A27	1 1/4	16.0
28	100B28	11.840	B	1 1/4	3 3/16	5	2	24.4	A	100A28	1 1/4	17.4
29	100B29	12.240	B	1 1/4	3 3/16	5	2	25.0	A	100A29	1 1/4	19.6
30	100B30	12.640	B	1 1/4	3 3/16	5	2	26.9	A	100A30	1 1/4	20.1
31		13.040							A	100A31	1 1/4	21.5
32	100B32	13.440	B	1 1/4	3 3/16	5	2	29.8	A	100A32	1 1/4	22.6
33		13.840							A	100A33	1 1/4	24.1
34		14.240							A	100A34	1 1/4	26.0
35	100B35	14.640	B	1 1/4	3 3/16	5	2 1/2	36.9	A	100A35	1 1/4	27.2
36	100B36	15.040	B	1 1/4	3 3/16	5	2 1/2	38.6	A	100A36	1 1/4	30.0
37		15.440							A	100A37	1 1/4	31.0
38	100B38	15.840	B	1 1/4	3 3/16	5	2 1/2	41.5	A	100A38	1 1/4	33.0
39	100B39	16.230	B	1 1/4	3 3/16	5	2 1/2	43.6	A	100A39	1 1/4	35.0
40	100B40	16.630	B	1 1/4	3 3/16	5	2 1/2	46.9	A	100A40	1 1/4	36.0
41		17.030							A	100A41	1 1/4	39.0
42	100B42	17.430	B	1 1/4	3 3/16	5	2 1/2	50.4	A	100A42	1 1/4	40.0
43		17.830							A	100A43	1 1/2	43.0
44		18.230							A	100A44	1 1/2	45.0
45	100B45	18.630	B	1 1/4	3 3/16	5	2 1/2	54.0	A	100A45	1 1/2	47.0
46		19.020							A	100A46	1 1/2	48.0
47		19.420							A	100A47	1 1/2	52.0
48	100B48	19.820	B	1 1/2	4	6	2 1/2	66.0	A	100A48	1 1/2	54.0
49		20.220							A	100A49	1 1/2	56.0
50		20.620							A	100A50	1 1/2	57.0
51		21.020							A	100A51	1 1/2	63.0
52		21.420							A	100A52	1 1/2	64.0
53		21.810							A	100A53	1 1/2	64.2
54	100C54	22.210	C	1 1/2	4	6	3 1/4	78.0	A	100A54	1 1/2	68.0
55		22.610							A	100A55	1 1/2	70.0
56		23.010							A	100A56	1 1/2	72.0
57		23.410							A	100A57	1 1/2	75.8
58		23.810							A	100A58	1 1/2	76.0
59		24.200							A	100A59	1 1/2	77.0
60	100C60	24.600	C	1 1/2	4	6	3 3/4	89.0	A	100A60	1 1/2	80.0
70	100C70	28.580	C	1 1/2	5 1/4	7	3 3/4	125	A	100A70	1 1/2	113
72	100C72	29.380	C	1 1/2	5 1/4	7	3 3/4	134	A	100A72	1 1/2	119
76	100C76	30.973	C	1 1/2	5 1/4	7	3 3/4	143	A	100A76	1 1/2	133
80	100C80	32.570	C	1 1/2	5 1/4	7	3 3/4	151	A	100A80	1 1/2	146
84	100C84	34.160	C	1 1/2	5 1/4	7	3 3/4	170	A	100A84	1 1/2	162
90	100C90	36.550	C	1 1/2	5 1/4	7	3 3/4	184	A	100A90	1 1/2	193
96	100C96	38.930	C	1 1/2	5 1/4	7	4 1/4	203	A	100A96	1 1/2	215

* Has recessed groove in hub for chain clearance.

Maximum bores shown will accommodate standard keyseat and setscrew over keyseat. Slightly larger bores are possible with no keyseat, shallow keyseat, or setscrew at angle to keyseat.

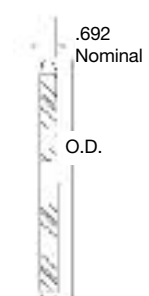

TYPE A

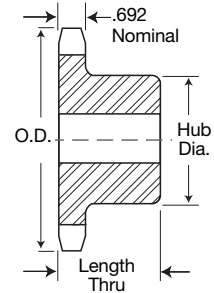

TYPE B

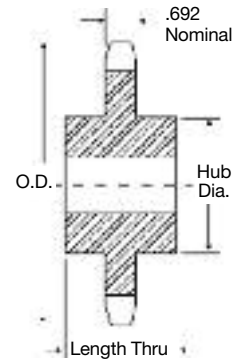

TYPE C

Alteration Charges

See current discount sheet for alteration charges.