

TYPE A

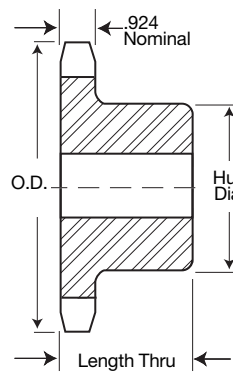

TYPE B

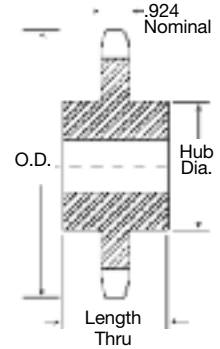

TYPE C

Single-Type B & C

Single-Type A

| No. Teeth | Catalog Number | Outside Diameter | Type | Bore (inches) | | Hub (inches) | | Weight Lbs. (Approx.) | Type | Catalog Number | Stock Bore | Weight Lbs. (Approx.) |
|-----------|----------------|------------------|------|---------------|-----------|--------------|-------------|-----------------------|------|----------------|------------|-----------------------|
| | | | | Stock | Rec. Max. | Dia. | Length Thru | | | | | |
| 8 | | 4.520 | | | | | | | A | 120A8 | 1½ | 2.4 |
| 9 | 120B9 | 5.020 | B | 1½ | 1⅞ | 3½* | 2½ | 5.3 | A | 120A9 | 1½ | 3.0 |
| 10 | 120B10 | 5.520 | B | 1½ | 2¼ | 3⅞* | 2½ | 7.1 | A | 120A10 | 1½ | 3.8 |
| 11 | 120B11 | 6.010 | B | 1½ | 2¾ | 3⅞ | 2½ | 7.6 | A | 120A11 | 1½ | 4.8 |
| 12 | 120B12 | 6.500 | B | 1½ | 2¾ | 4¼ | 2½ | 9.9 | A | 120A12 | 1½ | 5.8 |
| 13 | 120B13 | 6.990 | B | 1½ | 3 | 4⅞ | 2½ | 12.4 | A | 120A13 | 1½ | 6.7 |
| 14 | 120B14 | 7.470 | B | 1½ | 3¼ | 4¼ | 2½ | 14.4 | A | 120A14 | 1½ | 8.0 |
| 15 | 120B15 | 7.960 | B | 1½ | 3¾ | 4¾ | 2½ | 16.7 | A | 120A15 | 1½ | 9.1 |
| 16 | 120B16 | 8.440 | B | 1½ | 3¾ | 5¼ | 2½ | 19.9 | A | 120A16 | 1½ | 10.6 |
| 17 | 120B17 | 8.920 | B | 1½ | 3¾ | 5¼ | 2½ | 20.8 | A | 120A17 | 1½ | 12.6 |
| 18 | 120B18 | 9.410 | B | 1½ | 3¾ | 5¼ | 2½ | 22.2 | A | 120A18 | 1½ | 13.6 |
| 19 | 120B19 | 9.890 | B | 1½ | 3¾ | 5¼ | 2½ | 24.8 | A | 120A19 | 1½ | 15.1 |
| 20 | 120B20 | 10.370 | B | 1½ | 3¾ | 5¼ | 2½ | 25.8 | A | 120A20 | 1½ | 16.9 |
| 21 | 120B21 | 10.850 | B | 1½ | 3¾ | 5¼ | 2½ | 26.7 | A | 120A21 | 1½ | 18.7 |
| 22 | 120B22 | 11.330 | B | 1½ | 3¾ | 5¼ | 2½ | 28.2 | A | 120A22 | 1½ | 20.0 |
| 23 | 120B23 | 11.810 | B | 1½ | 3¾ | 5¼ | 2½ | 30.3 | A | 120A23 | 1½ | 22.1 |
| 24 | 120B24 | 12.290 | B | 1½ | 3¾ | 5¼ | 2½ | 32.1 | A | 120A24 | 1½ | 24.8 |
| 25 | 120B25 | 12.770 | B | 1½ | 3¾ | 5¼ | 2½ | 34.6 | A | 120A25 | 1½ | 26.8 |
| 26 | 120B26 | 13.250 | B | 1½ | 4 | 6 | 2½ | 40.0 | A | 120A26 | 1½ | 28.3 |
| 27 | | 13.730 | | | | | | | A | 120A27 | 1½ | 30.9 |
| 28 | 120B28 | 14.210 | B | 1½ | 4 | 6 | 2½ | 44.9 | A | 120A28 | 1½ | 33.6 |
| 30 | 120B30 | 15.170 | B | 1½ | 4 | 6 | 2½ | 50.2 | A | 120A30 | 1½ | 39.0 |
| 32 | 120B32 | 16.130 | B | 1½ | 4 | 6 | 2½ | 56.0 | A | 120A32 | 1½ | 43.9 |
| 33 | | 16.610 | | | | | | | A | 120A33 | 1½ | 48.2 |
| 34 | | 17.090 | | | | | | | A | 120A34 | 1½ | 50 |
| 35 | 120B35 | 17.570 | B | 1½ | 4 | 6 | 2½ | 62.4 | A | 120A35 | 1½ | 52 |
| 36 | 120B36 | 18.050 | B | 1½ | 4 | 6 | 2½ | 66.4 | A | 120A36 | 1½ | 56 |
| 40 | 120C40 | 19.960 | C | 1½ | 4 | 6 | 3¾ | 92.0 | A | 120A40 | 1½ | 71 |
| 42 | 120C42 | 20.920 | C | 1½ | 4 | 6 | 3¾ | 98.0 | A | 120A42 | 1½ | 75 |
| 45 | 120C45 | 22.350 | C | 1½ | 4 | 6 | 3¾ | 99.2 | A | 120A45 | 1½ | 88 |
| 48 | 120C48 | 23.790 | C | 1½ | 4 | 6 | 4 | 113 | A | 120A48 | 1½ | 103 |
| 54 | 120C54 | 26.650 | C | 1½ | 4 | 6 | 4 | 133 | A | 120A54 | 1½ | 140 |
| 60 | 120C60 | 29.520 | C | 1½ | 5¼ | 7 | 4 | 160 | A | 120A60 | 1½ | 160 |
| 70 | 120C70 | 34.300 | C | 1½ | 5¼ | 7¼ | 4¼ | 206 | A | 120A70 | 1½ | 216 |
| 80 | 120C80 | 39.080 | C | 1½ | 5¼ | 7¼ | 4¼ | 254 | A | 120A80 | 1½ | 284 |
| 90 | | 43.850 | | | | | | | A | 120A90 | 1½ | 358 |

Alteration Charges

See current discount sheet for alteration charges.

* Has recessed groove in hub for chain clearance.

Maximum bores shown will accommodate standard keyseat and setscrew over keyseat. Slightly larger bores are possible with no keyseat, shallow keyseat, or setscrew at angle to keyseat.