



Single-Type B

Single-Type A

| No. Teeth | Catalog Number | Outside Diameter | Type | Bore (inches) | | Hub (inches) | | Weight Lbs. (Approx.) | Type | Catalog Number | Stock Bore | Weight Lbs. (Approx.) |
|-----------|----------------|------------------|------|---------------|-----------|--------------|-------------|-----------------------|------|----------------|------------|-----------------------|
| | | | | Stock | Rec. Max. | Diameter | Length Thru | | | | | |
| 6 | 41B6 | 1.170 | B | 3/8 | 3/8 | 2 1/32* | 7/8 | .07 | | | | |
| 7 | 41B7 | 1.340 | B | 3/8 | 3/8 | 3/4* | 7/8 | .10 | | | | |
| 8 | 41B8 | 1.510 | B | 1/2 | 1/2 | 63/64* | 7/8 | .19 | | | | |
| 9 | 41B9 | 1.670 | B | 1/2 | 3/4 | 1 1/8* | 7/8 | .20 | | | | |
| 10 | 41B10 | 1.840 | B | 1/2 | 3/4 | 1 1/4* | 7/8 | .27 | | | | |
| 11 | 41B11 | 2.000 | B | 1/2 | 3/4 | 1 1/8* | 7/8 | .35 | | | | |
| 12 | 41B12 | 2.170 | B | 1/2 | 5/8 | 1 1/8* | 7/8 | .44 | | | | |
| 13 | 41B13 | 2.330 | B | 1/2 | 1 | 1 1/8 | 7/8 | .50 | | | | |
| 14 | 41B14 | 2.490 | B | 1/2 | 1 1/4 | 1 1/4 | 7/8 | .57 | A | 41A15 | 5/8 | .28 |
| 15 | 41B15 | 2.650 | B | 1/2 | 1 1/8 | 1 29/32 | 7/8 | .72 | A | 41A16 | 5/8 | .34 |
| 16 | 41B16 | 2.810 | B | 3/4 | 1 1/8 | 2 1/8 | 7/8 | .91 | A | 41A17 | 5/8 | .36 |
| 17 | 41B17 | 2.970 | B | 3/4 | 1 1/2 | 2 3/64 | 1 | 1.09 | A | 41A18 | 5/8 | .44 |
| 18 | 41B18 | 3.140 | B | 3/4 | 1 1/8 | 2 3/8 | 1 | 1.25 | A | 41A19 | 5/8 | .46 |
| 19 | 41B19 | 3.300 | B | 3/4 | 1 1/8 | 2 5/32 | 1 | 1.49 | A | 41A20 | 5/8 | .52 |
| 20 | 41B20 | 3.460 | B | 3/4 | 1 1/2 | 2 3/4 | 1 | 1.64 | A | 41A21 | 5/8 | .60 |
| 21 | 41B21 | 3.620 | B | 3/4 | 1 1/8 | 2 7/8 | 1 | 1.81 | A | 41A22 | 5/8 | .66 |
| 22 | 41B22 | 3.780 | B | 3/4 | 2 | 3 | 1 | 1.93 | A | 41A23 | 5/8 | .72 |
| 23 | 41B23 | 3.940 | B | 3/4 | 2 1/4 | 3 3/8 | 1 | 2.25 | A | 41A24 | 5/8 | .82 |
| 24 | 41B24 | 4.100 | B | 3/4 | 2 1/4 | 3 1/4 | 1 | 2.33 | A | 41A25 | 5/8 | .88 |
| 25 | 41B25 | 4.260 | B | 3/4 | 2 1/4 | 3 1/4 | 1 | 2.46 | A | 41A26 | 5/8 | .94 |
| 26 | 41B26 | 4.420 | B | 3/4 | 2 1/2 | 3 1/2 | 1 | 2.50 | A | 41A27 | 5/8 | 1.00 |
| 27 | 41B27 | 4.580 | B | 3/4 | 2 1/2 | 3 1/2 | 1 | 2.56 | A | 41A28 | 5/8 | 1.08 |
| 28 | 41B28 | 4.740 | B | 3/4 | 2 1/2 | 3 1/2 | 1 | 2.64 | A | 41A30 | 19/32 | 1.20 |
| 30 | 41B30 | 5.060 | B | 3/4 | 2 1/2 | 3 1/2 | 1 | 2.80 | A | 41A32 | 19/32 | 1.44 |
| 32 | 41B32 | 5.380 | B | 3/4 | 2 3/4 | 3 3/4 | 1 | 2.96 | A | 41A35 | 19/32 | 1.70 |
| 35 | 41B35 | 5.860 | B | 3/4 | 2 3/4 | 3 3/4 | 1 | 3.12 | A | 41A36 | 19/32 | 1.84 |
| 36 | 41B36 | 6.020 | B | 3/4 | 2 3/4 | 3 3/4 | 1 | 3.32 | A | 41A40 | 23/32 | 2.22 |
| 40 | 41B40 | 6.650 | B | 3/4 | 2 3/4 | 3 3/4 | 1 1/8 | 4.06 | A | 41A42 | 23/32 | 2.50 |
| 42 | 41B42 | 6.970 | B | 3/4 | 2 3/4 | 3 1/2 | 1 1/8 | 4.10 | A | 41A45 | 23/32 | 2.52 |
| 45 | 41B45 | 7.450 | B | 3/4 | 2 3/4 | 3 1/2 | 1 1/8 | 4.18 | A | 41A48 | 23/32 | 2.92 |
| 48 | 41B48 | 7.930 | B | 3/4 | 2 3/4 | 3 1/2 | 1 1/8 | 4.92 | A | 41A54 | 23/32 | 3.54 |
| 54 | 41B54 | 8.880 | B | 3/4 | 2 3/4 | 3 1/2 | 1 1/8 | 5.68 | A | 41A60 | 23/32 | 4.60 |
| 60 | 41B60 | 9.840 | B | 3/4 | 2 3/4 | 3 1/2 | 1 1/8 | 6.78 | A | 41A70 | 23/32 | 6.22 |
| 70 | 41B70 | 11.430 | B | 3/4 | 2 3/4 | 4 | 1 1/8 | 9.54 | A | 41A72 | 23/32 | 6.32 |
| 72 | 41B72 | 11.750 | B | 3/4 | 2 3/4 | 4 | 1 1/8 | 9.64 | A | 41A80 | 23/32 | 8.46 |
| 80 | 41B80 | 13.030 | B | 3/4 | 2 3/4 | 4 | 1 1/8 | 11.54 | A | 41A84 | 23/32 | 9.12 |
| 84 | 41B84 | 13.660 | B | 3/4 | 2 3/4 | 4 | 1 1/8 | 12.20 | A | 41A96 | 15/16 | 11.84 |
| 96 | 41B96 | 15.570 | B | 1 | 2 3/4 | 4 | 1 1/8 | 14.86 | A | 41A112 | 15/16 | 15.84 |
| 112 | 41B112 | 18.120 | B | 1 | 2 3/4 | 4 | 1 1/8 | 19.16 | A | | | |

* Has recessed groove in hub for chain clearance.

Maximum bores shown will accommodate standard keyseat and setscrew over keyseat.
Slightly larger bores are possible with no keyseat, shallow keyseat, or setscrew at angle to keyseat.

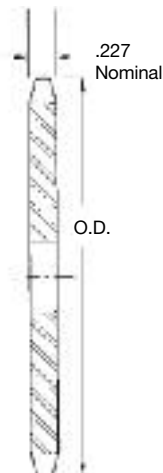

TYPE A

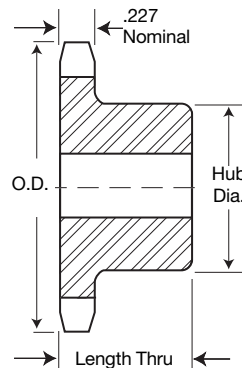

TYPE B