

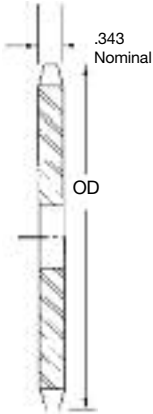

Single-Type B

Single-Type A



TYPE A

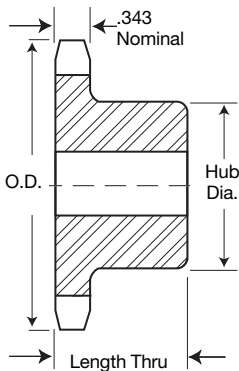

TYPE B

No. Teeth	Catalog Number	Outside Diameter	Type	Bore (inches)		Hub (inches)		Weight Lbs (Approx.)	Type	Catalog Number	Stock Bore	Weight Lbs. (Approx.)
				Stock	Rec. Max.	Diameter	Length Thru					
8	50B8	1.880	B	5/16	5/16	1 1/8*	1	.25				
9	50B9	2.090	B	5/16	5/16	1 1/8*	1	.36				
10	50B10	2.300	B	5/16	5/16	1 1/8*	1	.48				
11	50B11	2.500	B	5/16	1	1 1/8*	1	.64				
12	50B12	2.710	B	5/16	1 1/4	1 5/8*	1	.83	A	50A12	5/16	.34
13	50B13	2.910	B	5/16	1 1/4	1 1/2	1	.88	A	50A13	5/16	.42
14	50B14	3.110	B	5/16	1 1/4	2 1/8	1	1.13	A	50A14	5/16	.50
15	50B15	3.320	B	5/16	1 1/2	2 3/8	1	1.34	A	50A15	5/16	.54
16	50B16	3.520	B	5/16	1 1/2	2 1/2	1	1.51	A	50A16	5/16	.68
17	50B17	3.720	B	5/16	1 1/2	2 1/2	1	1.74	A	50A17	5/16	.76
18	50B18	3.920	B	5/16	1 1/2	2 1/2	1	2.00	A	50A18	5/16	.86
19	50B19	4.120	B	5/16	2	3	1	2.22	A	50A19	5/16	.94
20	50B20	4.320	B	5/16	2	3	1	2.28	A	50A20	5/16	1.06
21	50B21	4.520	B	5/16	2	3	1	2.40	A	50A21	5/16	1.12
22	50B22	4.720	B	5/16	2	3	1	2.56	A	50A22	5/16	1.30
23	50B23	4.920	B	5/16	2	3	1	2.66	A	50A23	5/16	1.44
24	50B24	5.120	B	5/16	2	3	1 1/4	3.30	A	50A24	23/32	1.50
25	50B25	5.320	B	5/16	2	3	1 1/4	3.40	A	50A25	23/32	1.62
26	50B26	5.520	B	5/16	2	3	1 1/4	3.44	A	50A26	23/32	1.72
27	50B27	5.720	B	5/16	2	3	1 1/4	3.74	A	50A27	23/32	1.96
28	50B28	5.920	B	5/16	2	3	1 1/4	3.80	A	50A28	23/32	2.04
29	50B29	6.120	B	5/16	2	3	1 1/4	4.06	A	50A29	23/32	2.36
30	50B30	6.320	B	5/16	2 1/4	3 1/4	1 1/4	4.56	A	50A30	23/32	2.54
31	50B31	6.520	B	5/16	2 1/4	3 1/4	1 1/4	4.74	A	50A31	23/32	2.80
32	50B32	6.720	B	5/16	2 1/4	3 1/4	1 1/4	4.96	A	50A32	23/32	2.72
33	50B33	6.920	B	5/16	2 1/4	3 1/4	1 1/4	5.20	A	50A33	23/32	3.14
34	50B34	7.120	B	5/16	2 1/4	3 1/4	1 1/4	5.14	A	50A34	23/32	3.20
35	50B35	7.320	B	5/16	2 1/4	3 1/4	1 1/4	5.44	A	50A35	23/32	3.34
36	50B36	7.520	B	5/16	2 1/4	3 1/4	1 1/4	5.64	A	50A36	23/32	3.82
37	50B37	7.720	B	5/16	2 1/4	3 1/4	1 1/4	5.90	A	50A37	23/32	3.98
38	50B38	7.920	B	5/16	2 1/4	3 1/4	1 1/4	6.08	A	50A38	23/32	4.14
39	50B39	8.120	B	5/16	2 1/4	3 1/4	1 1/4	6.30	A	50A39	23/32	4.42
40	50B40	8.320	B	5/16	2 1/4	3 1/4	1 1/4	6.50	A	50A40	23/32	4.46
41	50B41	8.520	B	5/16	2 1/4	3 1/4	1 1/4	6.64	A	50A41	23/32	4.86
42	50B42	8.720	B	5/16	2 1/4	3 1/4	1 1/4	6.96	A	50A42	23/32	4.98
43	50B43	8.910	B	5/16	2 1/4	3 1/4	1 1/4	7.06	A	50A43	23/32	5.24
44	50B44	9.110	B	5/16	2 1/4	3 1/4	1 1/4	7.58	A	50A44	23/32	5.42
45	50B45	9.310	B	5/16	2 1/4	3 1/4	1 1/4	8.58	A	50A45	23/32	5.92
46	50B46	9.510	B	1	2 1/2	3 1/4	1 1/4	8.22	A	50A46	15/16	6.42
47	50B47	9.710	B	1	2 1/2	3 1/4	1 1/4	8.48	A	50A47	15/16	6.50
48	50B48	9.910	B	1	2 1/2	3 1/4	1 1/4	9.28	A	50A48	15/16	6.58
49	50B49	10.110	B	1	2 1/2	3 1/4	1 1/4	9.22	A	50A49	15/16	7.06
50	50B50	10.310	B	1	2 1/2	3 1/4	1 1/4	9.88	A	50A50	15/16	7.10
51	50B51	10.510	B	1	2 1/2	3 1/4	1 1/4	9.70	A	50A51	15/16	7.32
52	50B52	10.710	B	1	2 1/2	3 1/4	1 1/4	10.24	A	50A52	15/16	7.98
53	50B53	10.910	B	1	2 1/2	3 1/4	1 1/4	10.48	A	50A53	15/16	8.08
54	50B54	11.110	B	1	2 1/2	3 1/4	1 1/4	11.00	A	50A54	15/16	8.30
55	50B55	11.310	B	1	2 1/2	3 1/4	1 1/4	10.93	A	50A55	15/16	8.56
56	50B56	11.500	B	1	2 1/2	3 1/4	1 1/4	11.50	A	50A56	15/16	8.90
57	50B57	11.700	B	1	2 1/2	3 1/4	1 1/4	12.00	A	50A57	15/16	9.38
58	50B58	11.900	B	1	2 1/2	3 1/4	1 1/4	11.82	A	50A58	15/16	10.30
59	50B59	12.100	B	1	2 1/2	3 1/4	1 1/4	12.32	A	50A59	15/16	10.50
60	50B60	12.300	B	1	2 1/2	3 1/4	1 1/4	13.00	A	50A60	15/16	10.80
70	50B70	14.290	B	1	2 1/2	3 1/4	1 1/4	18.16	A	50A70	15/16	14.00
72	50B72	14.690	B	1	2 1/2	3 1/4	1 1/4	19.48	A	50A72	15/16	15.24
76	50B76	15.486	B	1	2 1/2	3 1/4	1 1/4	21.00	A	50A76	15/16	20.08
80	50B80	16.280	B	1	2 3/4	4 1/4	1 1/4	24.74	A	50A80	15/16	21.00
84	50B84	17.080	B	1	2 3/4	4 1/4	1 1/4	25.50	A	50A84	15/16	22.08
95	50B95	19.270	B	1	2 3/4	4 1/4	1 1/4	32.00	A	50A95	15/16	27.00
96	50B96	19.470	B	1	2 3/4	4 1/4	1 1/4	32.92	A	50A96	15/16	27.40
112	50B112	22.650	B	1	2 3/4	4 1/4	1 1/4	42.00	A	50A112	15/16	37.70

\* Has recessed groove in hub for chain clearance.

Maximum bores shown will accommodate standard keyseat and setscrew over keyseat. Slightly larger bores are possible with no keyseat, shallow keyseat, or setscrew at angle to keyseat.

Alteration Charges

See current discount sheet for alteration charges.