



2.609 INCH (66.269MM) PITCH **SIMPLEX**

81X

2.609"
PITCH

78 - H74 - 75 - H75 - H78 - H78LR - H78RT - H78SR - 88 - 188 - S188
S78 - R588 - RR588 - R778 - RR778 - 988 - IS880 - 81X - IS882 - US881
LXS881 - LXS886 - LXS887 - LXS882 - 488 - XS578 - SS188 - C188
US278R - US882 - 578R - 588R

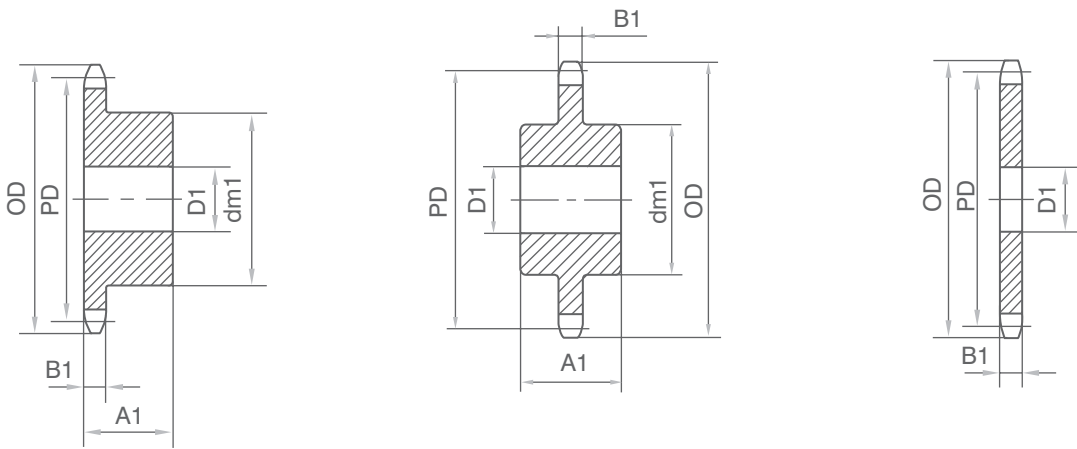

81X PLATE THICKNESS 7/8" ROLLER DIAMETER 7/8"

CATALOG NO.	Z	P.D	Stock Bore	Max Bore	Hub Diameter	A1	wt Lbs.	CATALOG NO.	Stock Bore	wt Lbs
81C08	8	6.82	15/16	3/4	43/4	3/8	21	81A08	15/16	9.0
81C09	9	7.63	1/4	37/16	51/4	37/8	29	81A09	1 1/4	11.3
81C10	10	8.44	1/4	37/16	51/4	37/8	31	81A10	1 1/4	13.9
81C11	11	9.26	1/4	37/16	51/4	37/8	34	81A11	1 1/4	16.7
81C12	12	10.08	1/4	37/16	51/4	37/8	37	81A12	1 1/4	19.8
81C13	13	10.90	1/4	33/4	51/2	41/2	46	81A13	1 1/4	23.0
81C14	14	11.72	1/4	33/4	51/2	41/2	49	81A14	1 1/4	27.0
81C15	15	12.55	1/2	33/4	51/2	41/2	53	81A15	1 1/2	30.0
81C17	17	14.20	1/2	33/4	51/2	41/2	62	81A17	1 1/2	39.0
81C19	19	15.85	1/2	41/2	61/2	53/8	90	81A19	1 1/2	50.0
81C21	21	17.51	1/2	41/2	61/2	53/8	101	81A21	1 1/2	61.0
81C24	24	19.99	1/2	41/2	61/2	53/8	119	81A24	1 1/2	79.0
81C25	25	20.82	1/2	41/2	61/2	53/8	124	81A25	1 1/2	84.0
81C28	28	23.31	1/2	41/2	61/2	53/8	132	81A28	1 1/2	105.0
81C30	30	24.96	1/2	41/2	61/2	53/8	150	81A30	1 1/2	123.0
81C35	35	29.11	1/2	41/2	61/2	53/8	170	81A35	1 1/2	166.0
81C40	40	33.25	1/2	415/16	71/4	63/4	226	81A40	1 1/2	216.0
81C42	42	34.91	1/2	415/16	71/4	63/4	240	81A42	1 1/2	240.0
81C46	46	38.31	1/2	415/16	71/4	63/4	258	81A46	1 1/2	286.0
81C54	54	44.87	1/2	415/16	71/4	63/4	368	81A54	1 1/2	302.0
81C60	60	49.85	1/2	415/16	71/4	63/4	388	81A60	1 1/2	322.0